

Options

Contour Valance

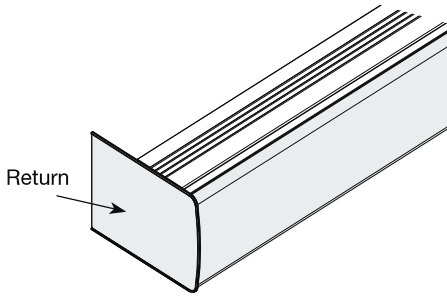

- **For surcharge, see price charts**
- A contoured PVC valance is available for all shades
- Spline and returns will be color coordinated
- Custom length returns are available from 2" to 5¼" (5.1 cm to 13.4 cm)
- The contour valance is not available with the dual shade or reverse roll
- Maximum width of the contour valance will depend on the maximum width of the chosen fabric and if the fabric can be rotated
- A valance only option is available for continuous-loop lift shades; single valance is available up to 144" (365.8 cm) in width to cover multiple shades with a single valance
- Valance fabric will not be oriented to the shade fabric (ex. on a patterned fabric, the pattern of the shade fabric and that of the valance fabric will **not** necessarily align)

NOTE: Returns can be trimmed to desired length with scissors or a utility knife.

Cassette Valance

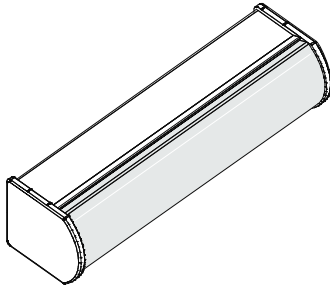

- **For surcharge, see price charts**
- A curved, sleek, aluminum-extruded, fabric covered valance is available as a surcharge option
- Valance fabric will not be oriented to the shade fabric (ex. on a patterned fabric, the pattern of the shade fabric and that of the valance fabric will **not** necessarily align)

NOTE: The curved cassette valance must be ordered at the same time as the shade.

Cassette Valance Availability

The cassette valance size is determined by multiple factors. Available cassette sizes by shade type are shown below.

	Small	Medium	Large
Continuous-Loop Lift	•	•	•
Motorized Lift	•	•	•
Cordless Lift	•	•	
Smart Pull Lift	•	•	
Dual Shade			•

NOTE: Fabric for cassette valances will be turned width for height. In cases of normal fabric orientation the pattern on the cassette valance will run perpendicular to the pattern on the shade. If the shade is railroaded, the pattern will be the same.

Fascia

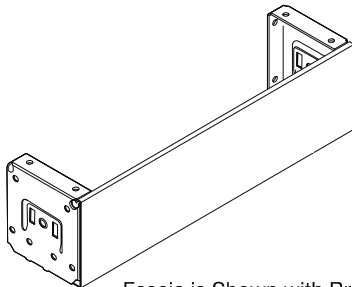

Fascia is Shown with Brackets

- **For surcharge, see price charts**
- Aluminum-extruded fascia is available in 3" and 4" (7.7 cm and 10.2 cm)
- Notchless fascia available (not available with SL30 clutch)
- Not available with smart pull lift, cordless lift, dual shades, and continuous fascia (one fascia for multiple shades)
- Color coordinated end covers are provided for outside mount
- Projection brackets are not available

NOTE: Fascia must be ordered at the same time as the shade.

Fascia Colors

Black.	939
Bronze	876
Clear Anodized.	875
Vanilla.	970
White	871

Options

Hem Bar



Fabric-Wrapped Hem Bar



Sealed Hem Bar

Fabric-Wrapped Hem Bar

- **No charge**
- Standard option
- Fabric from the shade is wrapped around an aluminum hem bar
- Color coordinated end caps

Sealed Hem Bar

- Hem bar is completely enclosed within a heat-sealed pocket
- Clean, smooth look
- No exposed parts
- Used in light commercial applications or in residential situations where a slim profile is needed
- Not available with cordless lift, smart pull lift, and scallop
- For available roller fabrics, see **fabric styles and information** section
- If material cannot be seamed, this option is not available

Blackout Channels

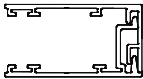

Side Channel

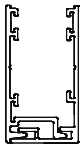
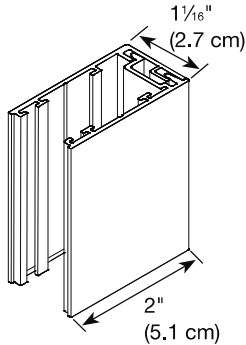

Sill Channel

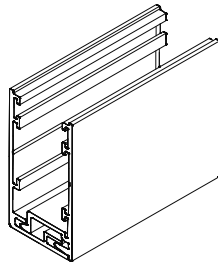

• For surcharge, see options pricing

- Blackout channels are extruded two-piece aluminum with synthetic pile inserts to eliminate light gaps
- Side and sill channels are available with all fabrics that can be seamed; see **fabric styles and information** section for fabrics that can be seamed
- Not available with dual shades or 3" (7.7 cm) fascia
- Manual shades: available for use with SL10, SL15, SL20, SL30 clutches, and 4" (10.2 cm) fascia
- Motorized lift shades: available with all motor types
- Blackout channels not available with external fabric-wrapped hem bar
- Side and sill channels need to be cut on site for appropriate fit

Colors

Black	939
Bronze	876
Clear Anodized	875
Vanilla	970
White	871

Commercial Solutions

- Coupled shades
 - Available with all fabrics that can be seamed except Cambridge RD, Epitome, Prodigy, and Whitehall
- Pockets

Please contact your customer service representative for additional information and ordering.